

SIDE EVENTS AND EXHIBITS BROCHURE



United Nations
Climate Change Conference

In line with the secretariat's efforts towards climate neutrality, this "Side Events and Exhibits" brochure will be available in electronic format only.

We invite participants to support this initiative by not printing the document or by printing only the necessary information.

Contents

| | |
|--|-----------|
| I. General information | 3 |
| A. Welcome..... | 3 |
| B. Observer Organizations Liaison Team | 5 |
| II. Side Events | 6 |
| A. UNFCCC and related events only | 6 |
| B. Schedule for all Side Events..... | 8 |
| III. Exhibits | 23 |
| A. List of Exhibits | 23 |
| B. Climate Change Kiosk | 28 |
| C. Climate Change Publications Counter..... | 28 |
| IV. Floor plans..... | 29 |
| A. Hotel Maritim Exhibit area..... | 29 |
| B. Hotel Maritim and surroundings..... | 30 |
| C. Ministry for the Environment (ground floor) | 31 |
| D. Ministry for the Environment (first floor)..... | 32 |
| E. Ministry of Transport (ground floor) | 33 |
| V. Observer organizations | 34 |
| A. NGO constituencies..... | 34 |
| B. Offices and contact information | 34 |
| C. Constituency meetings | 35 |
| VI. Logistics | 36 |
| A. Catering..... | 36 |
| B. Wi-Fi access | 36 |
| VII. Notices | 37 |

I. General information

A. Welcome

Welcome to the United Nations Climate Change Conference May 2012, host to the 36th sessions of the SBSTA and the SBI, the 17th session of the AWG-KP, the 15th session of the AWG-LCA and the 1st session of ADP, held at the Hotel Maritim. Bonn. In this brochure you will find information and contact details for all official Side Events and Exhibits to be held during the conference.

Access: Presenters and other participants of Side Events and/or Exhibits must be registered through a Party or an observer organization and in possession of a conference badge in order to access the conference venue.

Locations: Most Side Events are held at the Ministry for the Environment or the Ministry of Transport at Robert-Schuman-Platz, a three-minute walk from the Hotel Maritim.

- [Ministry for the Environment \(MoE\)](#): Rooms SOLAR and WIND
- [Ministry of Transport \(MoT\)](#): Rooms METRO and RAIL
- [Hotel Maritim](#): Rooms to be announced on the CCTV monitors

Exhibits are located in the foyer and the corridor between Saal Maritim and Saal Beethoven on the ground floor of the Hotel Maritim. Please consult the list of Exhibits on [page 23](#) and the floor plan on [page 29](#) for the exact locations of Exhibit booths.

Meeting schedule: For details on individual meetings, venues and other activities please consult the [UNFCCC website](#), the Daily Programme, the CCTV monitors or the noticeboards opposite the Information Counter in the foyer of the Hotel Maritim. Last-minute changes can be shown only on the CCTV monitors.

Daily Programme: The Daily Programme is available at the Documents Counter located in the foyer of the Hotel Maritim and on the [UNFCCC website](#). The Daily Programme provides detailed information on all scheduled meetings of the Convention bodies meetings of other groups, and announcements relevant to the conference.

In addition to the Daily Programme, all official documents and the list of participants are available at the Documents Counter. UNFCCC documents are also available in the "[Documents](#)" section of the UNFCCC website.

Pigeonholes: Please refer to the "[Information for Participants](#)" brochure.

Reception

Monday, 14 May 2012 at 7 p.m.

A reception hosted by the Federal Ministry for the Environment, Nature Protection and Nuclear Safety and the City of Bonn will take place at
Kunst- und Ausstellungshalle der Bundesrepublik Deutschland
(Underground station: Heussallee/Museumsmeile)
Museumsmeile Bonn, Friederich-Ebert-Allee 4, 53113 Bonn

All conference participants are warmly invited.

B. Observer Organizations Liaison Team

The Observer Organizations Liaison Team is located in the Hotel Maritim.

The following members of the team are based in the Conference Affairs Services office in La Marée, on the ground floor of the Hotel Maritim:

Ms. Megumi Endo
Observer Organizations Liaison Officer
mendo@unfccc.int

Ms. Susan Brandmeir
Briefings, In-session Workshop
sbrandmeir@unfccc.int

Mr. Warren Waetford
Additional Activities
wwaetford@unfccc.int

Staff based at the Side Events and Exhibits Coordination Office on the ground floor of the Hotel Maritim, next to the Information Counter:

Ms. Edith Kimotho
Side Events and Exhibits
ekimotho@unfccc.int

Mr. Pedro Hermes Cornejo Soriano
Side Events and Exhibits
pcornejosoriano@unfccc.int

II. Side Events

The Side Event programme for the United Nations Climate Change Conference May 2012 contains **76** events focused on major issues in the Convention process. Side Events will take place at the following locations:

- [Ministry for the Environment \(MoE\)](#): Rooms SOLAR and WIND
- [Ministry of Transport \(MoT\)](#): Rooms METRO and RAIL
- [Hotel Maritim](#): Rooms to be announced on the CCTV monitors

For a breakdown of the Side Events, please see our [web schedule](#), which allows events to be sorted by category as well as by organizer group.

Make your presentations available to a global audience

An upload facility is available to all Side Event organizers for uploading draft agendas in advance and sharing presentation files with participants after the event. The upload facility is also available to all Exhibit organizers for uploading electronic publications to the UNFCCC website. The facility can be accessed on the online registration system through your personal account. Changes can be made by replacing or deleting the existing files up to four weeks after the sessions. Please note that individual files should not exceed 4 MB, but you may upload as many files as needed.

A. UNFCCC and related events only

UNFCCC and related events are listed in the table below.

Locations:

MoE (Ministry for the Environment, first floor): Rooms WIND and SOLAR

MoE (Ministry for the Environment): Rooms METRO and RAIL

Hotel Maritim: For rooms, please consult the CCTV monitors

Category:

| |
|-------------------------------|
| Adaptation and related issues |
| Mitigation and related issues |
| Cross-cutting issues |
| Others |

| Time/Room | Organizer | Title / Theme / speakers |
|--|--|--|
| Monday, 14 May 13:15–14:45 RAIL (MoT) | Secretariat of the United Nations Framework Convention on Climate Change (UNFCCC) Ms. Uazamo Kaura ukaura@unfccc.int +49 228 8151474 | Latest submissions of national communications from non-Annex I Parties The side-event will consist of presentations of the latest submissions of national communications from non-Annex I Parties, followed by a Q&A session and general discussion. |

| Time/Room | Organizer | Title / Theme / speakers |
|---|---|--|
| Monday, 14 May 13:15–14:45 WIND (MoE) | CANCELLED by Organizer Global Environment Facility (GEF) Mr. Marcelo Jordan rmjordan@thegef.org +1 240 7556904 | CANCELLED by Organizer Adaptation Fund: Achievements and Approaching Challenges The Adaptation Fund is pioneering a number of innovative features to mobilize funding and facilitate access to it for concrete adaptation activities. This side event intends to provide an update on the status of work, with particular focus on the implementation of the direct access modality. |
| Tuesday, 15 May 13:15–14:45 TBC | Secretariat of the United Nations Framework Convention on Climate Change (UNFCCC) Ms. Kay Merce kmerce@unfccc.int +49 228 8151507 | CDM Executive Board: question and answer session The Executive Board of the CDM will report on its activities and answer questions from the audience |
| Tuesday, 15 May 18:15–19:45 SOLAR (MoE) | Secretariat of the United Nations Framework Convention on Climate Change (UNFCCC) Mr. Motsomi Maletjane mmaletjane@unfccc.int +49 228 8151324 | Work of the LEG in supporting NAPAs and NAPs in LDCs The LEG will share its work in supporting NAPAs and NAPs in LDCs, focusing on activities in 2011 and those planned for 2012. Together with LDC Parties, the LEG will also share experiences, best practices and lessons learned on NAPA and the LDC work programme, and how these can inform the NAP process |
| Thursday, 17 May 13:00–15:00 SAAL HAYDN (Hotel Maritim) | Secretariat of the United Nations Framework Convention on Climate Change (UNFCCC) Mr. Niclas Svenningsen nsvenningsen@unfccc.int +49 228 8151982 | High-level Panel on the CDM Policy Dialogue - Stakeholder Consultations The High-Level Panel on the CDM Policy Dialogue will facilitate consultations with wide range of stakeholders regarding the readiness and future positioning of the CDM to meet the challenges of the post-2012 period and the future context of the Market-Based Mechanisms. |
| Thursday, 17 May 13:15–14:45 SAAL SCHUMANN (Hotel Maritim) | Secretariat of the United Nations Framework Convention on Climate Change (UNFCCC) Mr. Alejandro Kilpatrick akilpatrick@unfccc.int +49 228 8151764 | Consultations by the co-chairs of the work programme on long-term finance This two-part event will offer the Co-Chairs the opportunity to receive valuable inputs related to the work programme on long-term finance. |
| Monday, 21 May 18:00–19:30 SAAL BEETHOVEN (Hotel Maritim) | Secretariat of the United Nations Framework Convention on Climate Change (UNFCCC) Mr. Alejandro Kilpatrick akilpatrick@unfccc.int +49 228 8151764 | Consultations by the co-chairs of the work programme on long-term finance This two-part event will offer the Co-Chairs the opportunity to receive valuable inputs related to the work programme on long-term finance. |
| Thursday, 24 May 13:15–14:45 TBC | Secretariat of the United Nations Framework Convention on Climate Change (UNFCCC) Ms. Kay Merce kmerce@unfccc.int +49 228 8151507 | Joint Implementation Supervisory Committee: question and answer session The Joint Implementation Supervisory Committee will explain its work programme and the progress made so far, and answer questions from the audience |

B. Schedule for all Side Events¹

Pages 8–23 below display all Side Events planned for the conference, in chronological order. The Side Events have been colour-coded by category, as indicated by the organizers. The “Others” category includes events whose organizers did not associate themselves with any of the three categories.

Categories

| | |
|--|-------------------------------|
| | Adaptation and related issues |
| | Mitigation and related issues |
| | Cross-cutting issues |
| | Others |

Locations

MoE (Ministry for the Environment, first floor): Rooms WIND and SOLAR

MoT (Ministry of Transport, ground floor): Rooms METRO and RAIL

Hotel Maritim: For rooms, please consult the CCTV monitors

| Time/Room | Organizer | Title / Theme / speakers |
|---|--|--|
| Monday, 14 May 13:15–14:45 METRO (MoT) | ICLEI-Local Governments for Sustainability (ICLEI) Mr. Yunus Arikan yunus.arikan@iclei.org +49 228 97629920 | Launching Global Protocol for Community-Scale GHG Emissions (GPC) Developed by ICLEI and C40, in collaboration with WB-UNEP-UNHABITAT and WRI, Global Protocol for Community-Scale GHG Emissions (GPC) supports local, national, and global climate mitigation efforts by standardizing how communities quantify and report their GHG emissions. Speakers: High level representatives and experts of ICLEI, C40, WB, WRI |
| Monday, 14 May 13:15–14:45 RAIL (MoT) | Secretariat of the United Nations Framework Convention on Climate Change (UNFCCC) Ms. Uazamo Kaura ukaura@unfccc.int +49 228 8151474 | Latest submissions of national communications from non-Annex I Parties The side-event will consist of presentations of the latest submissions of national communications from non-Annex I Parties, followed by a Q&A session and general discussion. |
| Monday, 14 May 13:15–14:45 WIND (MoE) | CANCELLED by Organizer Global Environment Facility (GEF) Mr. Marcelo Jordan rmjordan@thegef.org +1 240 7556904 | CANCELLED by Organizer Adaptation Fund: Achievements and Approaching Challenges The Adaptation Fund is pioneering a number of innovative features to mobilize funding and facilitate access to it for concrete adaptation activities. This side event intends to provide an update on the status of work, with particular focus on the implementation of the direct access modality. |

¹ Titles and descriptions of Side Events have been reproduced as received.

| Time/Room | Organizer | Title / Theme / speakers |
|--|---|--|
| Tuesday, 15 May 13:15–14:45 METRO (MoT) | China Mr. Ji Chen chenji@ccchina.gov.cn +86 10 68501567 | The framework of Equitable Access to Sustainable Development Speakers will present how equitable access to sustainable development relates to historical responsibilities, equitable burden sharing and sustainable development, and how this approach can contribute to the negotiation up to and beyond 2020. |
| Tuesday, 15 May 13:15–14:45 WIND (MoE) | International Maritime Organization (IMO) Ms. Lucy Essuman lessuman@imo.org +44 207 4634210 | Control of greenhouse gas emissions from international transport A panel will debate how GHG emissions from international shipping should be regulated. The side event will focus on IMO's work on technical, operational and market-based reduction measures for international shipping. |
| Tuesday, 15 May 13:15–14:45 TBC | Secretariat of the United Nations Framework Convention on Climate Change (UNFCCC) Ms. Kay Merce kmerce@unfccc.int +49 228 8151507 | CDM Executive Board: question and answer session The Executive Board of the CDM will report on its activities and answer questions from the audience |
| Tuesday, 15 May 13:15–14:45 RAIL (MoT) | Secretariat of the Convention on Biological Diversity (CBD) Ms. Annie Cung annie.cung@cbd.int +1 514 2877045 | The Rio Conventions – to Rio and Beyond The event will demonstrate the contribution of synergies among the Rio Conventions to sustainable development. Political support is highlighted by the proposed statement on synergies among the Rio Conventions from the Joint Liaison Group while national case studies provide on the ground examples. |
| Tuesday, 15 May 18:15–19:45 WIND (MoE) | GERMANWATCH Ms. Charlotte Cuntz cuntz@germanwatch.org +49 228 6049234 | Earmarking the EU ETS-Revenues for climate action: a way forward for the EU ETS aviation dispute? Earmarking all EU ETS revenues for climate action is an innovative approach for climate financing, which must gain more acceptance in the EU. The event hosted by Germanwatch and Oxford Institute for Energy Studies will discuss if such approaches offer a chance to advance in the ETS aviation dispute. Speakers: Christoph Bals (Germanwatch) Benito Müller (OIES) Arthur Runge-Metzger (tbc) Further speakers |
| Tuesday, 15 May 18:15–19:45 METRO (MoT) | International Energy Agency (IEA) Ms. Jenny GELL jenny.gell@iea.org +33 75015 3314057672 | Energy & Climate Policy: latest analyses from the IEA Presentations will cover: Robust energy & climate policy packages (with sneak preview of forthcoming China Electricity Report; tracking progress on energy & climate; and Carbon Capture & Storage - the critical decade. Speakers: Chair: Philippe Benoit; Speakers: Richard Baron, Antonia Gawel, Ellina Levina. |

| Time/Room | Organizer | Title / Theme / speakers |
|--|---|--|
| <p>Tuesday, 15 May 18:15–19:45 SOLAR (MoE)</p> | <p>Secretariat of the United Nations Framework Convention on Climate Change (UNFCCC) Mr. Motsomi Maletjane mmaletjane@unfccc.int +49 228 8151324</p> | <p>Work of the LEG in supporting NAPAs and NAPs in LDCs The LEG will share its work in supporting NAPAs and NAPs in LDCs, focusing on activities in 2011 and those planned for 2012. Together with LDC Parties, the LEG will also share experiences, best practices and lessons learned on NAPA and the LDC work programme, and how these can inform the NAP process</p> |
| <p>Tuesday, 15 May 18:15–19:45 RAIL (MoT)</p> | <p>Denmark Mr. Peter Larsen pla@ens.dk +45 4 1188431</p> | <p>Experience sharing on how to set national emissions baselines in developing countries There are currently no international standards or guidelines for baseline setting under the UNFCCC. The Danish Energy Agency together with the OECD and UNEP Risø will publish later this year a compilation of national experiences with baseline development in ten non-Annex I countries.</p> |
| <p>Tuesday, 15 May 20:00–21:30 RAIL (MoT)</p> | <p>Munich Climate Insurance Initiative (MCII) Ms. Koko Warner warner@ehs.unu.edu +49 228 8150226</p> | <p>Loss & Damage: From regional insurance pool to local weather protection in the Caribbean MCII presents updates from the Caribbean Adaptation & Insurance program which links disaster risk reduction & insurance through public-private partnership to help low-income people.</p> <p>Speakers: Koko Warner (moderation) Ekhosuehi Iyehen (CCRIF) Grenada representative (tbd) Jamaica representative (tbd) St. Lucia representative (tbd) Thomas Loster, Munich Re Foundation Richard Leftley, Microinsure</p> |
| <p>Tuesday, 15 May 20:00–21:30 METRO (MoT)</p> | <p>Food and Agriculture Organization of the United Nations (FAO) Ms. Emelyne Cheney Emelyne.cheney@fao.org +39 34 25108119</p> | <p>Building resilience for adaptation to climate change in the agricultural sectors Building resilience is central to preparing for future changes, as it enables to consider interactions between ecosystems, economic, social and institutional domains at various scales. The event will offer different approaches for building resilience in agriculture for adaptation to climate change.</p> |
| <p>Tuesday, 15 May 20:00–21:30 WIND (MoE)</p> | <p>European Union Ms. Bianca Neagu bianca.neagu@ec.europa.eu +32 2 2962478</p> | <p>CLIMATE-ADAPT: European Climate Adaptation Platform The European Climate Adaptation Platform (CLIMATE-ADAPT), launch in March 2012, is an online tool designed to support policy-makers at EU, national, regional and local levels in the development of climate change adaptation measures and policies. A live presentation of CLIMATE-ADAPT will be provided.</p> |

| Time/Room | Organizer | Title / Theme / speakers |
|--|---|--|
| <p>Wednesday, 16 May 13:15–14:45 METRO (MoT)</p> | <p>Germany Ms. Beatrice Ladusch beatrice.ladusch@bmu.bund.de +4 3018 3052326</p> | <p>Making climate finance work: Perspectives from different actors Parties are confronted with a variety of international climate finance mechanisms and need to prepare for the Green Climate Fund (GCF). The side event will discuss perspectives from different actors regarding needs and experiences in adaptation and mitigation finance. Speakers include implementing, providing and analytical perspectives on climate finance.</p> <p>Speakers: Representatives from developing country, German government, climate funds, NGO, think tank</p> |
| <p>Wednesday, 16 May 13:15–14:45 RAIL (MoT)</p> | <p>Centre for Community Economics and Development Consultants Society (CECOEDECON) Mr. Sharad Joshi sharad_jp1@sancharnet.in +91 141 2771488</p> | <p>Work programme on Agriculture; Priorities for Small holders The COP 17 outcome document of the AWG ALC instructed the SBSTA to consider undertaking a work programme on agriculture in SBSTA 36th Meeting, and invited views of parties and observer organizations on issues related to agriculture. The views submitted to UNFCCC secretariat predominantly calls for i</p> <p>Speakers: Ajay Kumar Jha Soumya Dutta Sharad Joshi</p> |
| <p>Wednesday, 16 May 13:15–14:45 WIND (MoE)</p> | <p>WMO/UNEP Intergovernmental Panel on Climate Change (IPCC) Mr. Gaetano Leone gleone@wmo.int +41 22 7308247</p> | <p>“Software for the 2006 IPCC Guidelines” “The IPCC Task Force on Inventories will demonstrate and make available new software for the 2006 IPCC Guidelines for National Greenhouse Gas Inventories. This software can help all countries prepare estimates of their GHGs but is primarily for developing countries and those with limited resources.”</p> |
| <p>Wednesday, 16 May 18:15–19:45 WIND (MoE)</p> | <p>Center for International Forestry Research (CIFOR) Ms. Levanía Santoso lsantoso@cgiar.org +62 251 8622622</p> | <p>Insights in REDD+ realities: Politics, MRV and Benefit Sharing CIFOR & partners will examine the politics of benefit sharing and reference levels based on a global comparison of country experiences, among them Indonesia and Brazil. We will identify opportunities and obstacles in the REDD policy and MRV arena and provide lessons for constructive solutions.</p> <p>Speakers: Chair: Markku Kanninen, University of Helsinki Panelists: - From BAU to CHANGE: institutions, ideas, interests, and information – How to conceptualise the politics of REDD+ ? (Maria Brockhaus, CIFOR) - Understanding the political economy of REDD+ - What are constraints for effective policy making in REDD+? (Monica Di Gregorio, Leeds University) - Benefit sharing in REDD+ - Who ‘should’ benefit? (Lasse Loft, Biodiversity and Climate Research Centre) - MRV in REDD+ - How to link MRV to benefit sharing? (Lou Verchot, CIFOR)</p> |

| Time/Room | Organizer | Title / Theme / speakers |
|--|--|--|
| Wednesday, 16 May 18:15–19:45 METRO (MoT) | Climate Action Network - Europe (CAN - Europe) Mr. Eddy de neef eddy@caneurope.org +32 2 8944670 | Ambition and equity - How to close the gap Assessment of the current mitigation pledges and the need to address equity principles to close the ambition gap. |
| Wednesday, 16 May 18:15–19:45 RAIL (MoT) | United Nations Development Programme (UNDP) Ms. Jennifer Baumwoll jennifer.baumwoll@undp.org +1 212 9065012 | Using National Investment and Financial Flows Analyses to Support Climate Finance Readiness UNDP has been supporting 15 developing countries to assess the investments required to implement priority adaptation & mitigation measures, including financial flows. The capacities built during this process put the countries in good stead to access future climate finance. Speakers: Representatives from The Gambia, Liberia, and Colombia (tbc), UNDP |
| Wednesday, 16 May 18:15–19:45 SOLAR (MoE) | Centre for European Policy Studies (CEPS) Ms. Monica Alessi monica.alessi@ceps.eu +32 472 721868 | Carbon markets and new mechanisms: architecture and modalities & procedures CEPS Carbon Market Forum presents an interim Task Force report on New Market Mechanisms. It examines issues such as the modalities and procedures (M&P) for the New Mechanism defined in Durban, the role of the Framework, the role of the UNFCCC, interactions with NAMAs and proposes possible options. Speakers: - P. Barata - Moderator - A. Marcu will present the Interim CEPS Report Commentaries - G. Bertolino ENEL - J.-Y. Caneill EdF - Eva Filzmoser CDM Watch - EC representative - South Africa representative - Australia representative |
| Wednesday, 16 May 20:00–21:30 RAIL (MoT) | Transport Research Foundation (TRF) Ms. Anne Binsted abinsted@trl.co.uk +44 1344 770568 | Bridging the Gap between transport and climate change This event will present recent findings from TRF, GIZ, UITP, Veolia Transdev & ITDP on transport NAMAs & related opportunities to build capacity & achieve sustainable climate change mitigation from land transport. Experts and negotiators will discuss topical issues such as climate finance & MRV. |
| Wednesday, 16 May 20:00–21:30 SOLAR (MoE) | Organisation for Economic Co-operation and Development (OECD) Ms. Jane Ellis jane.ellis@oecd.org +33 61 970401 | Tracking and mobilising climate finance There are many challenges to tracking and mobilising climate finance. This side event will highlight the results from recent analyses from the OECD and Climate Change Expert Group |
| Wednesday, 16 May 20:00–21:30 METRO (MoT) | Institute for Global Environmental Strategies (IGES) Mr. Akihisa Kuriyama kuriyama@iges.or.jp +81 46 8269605 | The road to the Durban Platform: New framework, New market Mechanisms and MRV in Asia This side event will focus on emerging issues in Asia under a new framework after Durban including climate unilateralism, development of MRV on new market mechanisms, quality-of-governance standards for REDD+, and energy scenarios in Japan after the Fukushima accident. It will present IGES's own analysis and take of these current issues. |

| Time/Room | Organizer | Title / Theme / speakers |
|---|---|--|
| <p>Thursday, 17 May 13:00–15:00 SAAL HAYDN (Hotel Maritim)</p> | <p>Secretariat of the United Nations Framework Convention on Climate Change (UNFCCC) Mr. Niclas Svenningsen nsvenningsen@unfccc.int +49 228 8151982</p> | <p>High-level Panel on the CDM Policy Dialogue - Stakeholder Consultations The High-Level Panel on the CDM Policy Dialogue will facilitate consultations with wide range of stakeholders regarding the readiness and future positioning of the CDM to meet the challenges of the post-2012 period and the future context of the Market-Based Mechanisms.</p> |
| <p>Thursday, 17 May 13:15–14:45 WIND (MoE)</p> | <p>World Meteorological Organization (WMO) Mr. Amir Delju adelju@wmo.int +41 22 7308360</p> | <p>Progress with the Global Framework for Climate Services (GFCS) WMO and its partners are working on a detailed implementation plan and governance structure of the GFCS designed to enable producers, researchers and user organizations to lift the quality and volume of climate services worldwide. It will be presented at WMO's Extraordinary Congress in Oct. 2012.</p> <p>Speakers: WMO, UNCCD, UNFCCC, GCOS, Germany, Switzerland</p> |
| <p>Thursday, 17 May 13:15–14:45 METRO (MoT)</p> | <p>Liechtenstein Mr. Sven Braden braden@klimastiftung.li +4 23 2367451</p> | <p>New Market Mechanisms - Creating demand and safeguarding incentives While new mechanisms seem to enlarge the scope of mitigation in countries without commitments, the question of incentives has so far been neglected. Researchers and representatives of emitters discuss options for stable incentives, as well as the demand required to make new mechanisms a success.</p> <p>Speakers: to be announced</p> |
| <p>Thursday, 17 May 13:15–14:45 SAAL SCHUMANN (Hotel Maritim)</p> | <p>Secretariat of the United Nations Framework Convention on Climate Change (UNFCCC) Mr. Alejandro Kilpatrick akilpatrick@unfccc.int +49 228 8151764</p> | <p>Consultations by the co-chairs of the work programme on long-term finance This two-part event will offer the Co-Chairs the opportunity to receive valuable inputs related to the work programme on long-term finance.</p> |
| <p>Thursday, 17 May 18:15–19:45 WIND (MoE)</p> | <p>Global Forest Coalition (GFC) Ms. Simone Lovera simone.lovera@globalforestcoalition.org +595 21 663654</p> | <p>Contradictions in the Bioeconomy: REDD+, Bioenergy and alternative biocultural approaches The event will present an analysis of the contradictions in the bioeconomy and other "green economy" policies that are promoted within the Rio+20 process. It will present alternative biocultural approaches including Indigenous territories and community conserved areas, and biocultural protocols</p> <p>Speakers: Onel Masardule, FPCI, Panama Simone Lovera, GFC, Paraguay Alejandro Argumedo, Asociacion ANDES, Peru Deepak Rughani, Biofuelwatch, UK La Via Campesina (tbc)</p> |

| Time/Room | Organizer | Title / Theme / speakers |
|---|---|--|
| <p>Thursday, 17 May 18:15–19:45 METRO (MoT)</p> | <p>Global Environment Centre Foundation (GEC) Mr. Tomoya Motoda cdm-fs@gec.jp +81 6 69154122</p> | <p>Toward the Establishment the Bilateral Offset Credit Mechanism (BOCM) – Utilisation to Support the NAMA Implementation The side event will present the overview of Japanese programme on the Bilateral Offset Credit Mechanism (BOCM), and its possible utilisation for NAMAs in developing countries. Developing countries representatives will also show their perspectives on BOCM and their NAMAs/climate national strategies.</p> <p>Speakers: Japanese Ministry of the Environment, Mongolian Ministry of Nature, Environment, and Tourism, Lao Ministry of Natural Resources and Environment, Global Environment Centre Foundation (GEC), Institute for Global Environmental Strategies (IGES), and Overseas Environmental Cooperation Center (OECC)</p> |
| <p>Thursday, 17 May 18:15–19:45 SOLAR (MoE)</p> | <p>World Federation of Engineering Organizations (WFEO) Mr. Darrel Danyluk ddanyluk@shaw.ca +1 403 2380379</p> | <p>“Climate Vulnerability Assessment Update and Key strategies and economic, social environment costs” The PIEVC Climate Vulnerability assessment protocol assesses climate impacts in terms of economic, social and environmental factors. Its information assists decision makers prioritize allocate resources. Includes update on Costa Rica, Honduras and developing in-country capacity.</p> <p>Speakers: Engineer David Lapp Engineer Paul Fesko Engineer Darrel Danyluk Engineer Brent Burton</p> |
| <p>Thursday, 17 May 18:15–19:45 RAIL (MoT)</p> | <p>World Resources Institute (WRI) Ms. Raquel Gonzalez raquelgonzalez@gmail.com +1 202 7297847</p> | <p>Following the money: Reviewing fast-start finance contributions It is imperative to understand where and how developed countries are delivering on their climate finance pledges. This event presents case studies of UK and US activities, based on the Open Climate Network, a partnership of researchers and civil society to track country progress on climate change.</p> |
| <p>Thursday, 17 May 20:00–21:30 WIND (MoE)</p> | <p>Wetlands International Ms. Susanna Tol susanna.tol@wetlands.org +0 6717 3162262470</p> | <p>Launch of global 'Organic Soils and Peatlands Climate Change Mitigation Initiative FAO and Wetlands International invite you to the launch of the global 'Organic Soils and Peatlands Climate Change Mitigation Initiative'. We present the activities of the Initiative to promote emissions reductions from peatlands/organic soils worldwide under REDD+, NAMA's and LULUCF.</p> <p>Speakers: Speakers include representatives from FAO, UNEP, IUCN, Greifswald University and Wetlands International.</p> |

| Time/Room | Organizer | Title / Theme / speakers |
|---|---|--|
| <p>Thursday, 17 May 20:00–21:30 RAIL (MoT)</p> | <p>German Development Institute (DIE - Bonn) Ms. Britta Horstmann Britta.Horstmann@die-gdi.de +49 228 94927208</p> | <p>Adaptation Fund: ensuring transparency and accountability An effective use of funds is key for a successful operation of the Adaptation Fund. How can the Adaptation Fund promote transparency and accountability and what are related challenges? What are lessons learnt, e.g. for the Green Climate Fund?</p> |
| <p>Thursday, 17 May 20:00–21:30 METRO (MoT)</p> | <p>The Nature Conservancy (TNC) Mr. Christopher Heishman cheishman@tnc.org +1 703 8413921</p> | <p>Confronting China's climate challenges – nature based solutions to mitigation and adaptation China has brought natural resources management into the center of its latest 5-year plan & national development strategy, including nature based solutions to climate change mitigation & adaptation. New tools & on the ground projects will be presented & put in the context of this national strategy.</p> <p>Speakers: Wang Chunfeng (China's leading negotiator of Forest Carbon); Li Yue (China's leading negotiator of Climate Change Adaptation); Ma Jian (Director, TNC China Climate Change Project); Zhang Xiaoquan (Senior Scientist, TNC China); Sascha Müller-Kraenner (Director, TNC Europe)</p> |
| <p>Thursday, 17 May 20:00–21:30 SOLAR (MoE)</p> | <p>National Wildlife Federation (NWF) Ms. Nathalie Walker walkern@nwf.org +1 202 5529773</p> | <p>Addressing the Drivers of Emissions from Deforestation and Forest Degradation CI, EDF, NWF, RSPB and UCS present recommendations for addressing drivers of deforestation, including low emissions development strategies, land use planning, leakage prevention and legal production of commodities.</p> <p>Speakers: The event will have speakers from Conservation International, Environmental Defense Fund, National Wildlife Federation, the Royal Society for the Protection of Birds and Union of Concerned Scientists.</p> |
| <p>Friday, 18 May 13:15–14:45 WIND (MoE)</p> | <p>Potsdam Institute for Climate Impact Research (PIK) Mr. Gunnar Luderer luderer@pik-potsdam.de +49 331 2882671</p> | <p>New scenarios – Can 2°C still be reached starting from 2020 pledges? PIK, PBL, IIASA and Ecofys will provide insights from models on conditions, risks and costs of emission trajectories that are based on countries' 2020 pledges and still aim at limiting global temperature increase to 2°C. Scenarios of this kind have not been evaluated by scientific literature yet.</p> <p>Speakers: Dr. Niklas Hoehne, ECOFYS Prof. Keywan Riahi, IIASA Dr. Michel den Elzen, PBL Joeri Roeglj, ETH Zuerich Dr. Gunnar Luderer, PIK</p> |

| Time/Room | Organizer | Title / Theme / speakers |
|---|---|--|
| <p>Friday, 18 May 13:15–14:45 METRO (MoT)</p> | <p>Japan Mr. Hiroshi Seike hiroshi.seike@mofa.go.jp +81 3 55018493</p> | <p>Low Carbon Growth in East Asia and Japan's Effort This side event focuses on various kinds of cooperation on climate change especially in the East Asia Summit(EAS)region. Japanese government and other relevant institutions will present various activities and initiatives to cooperate regionally and bilaterally.</p> <p>Speakers: Japanese government and other relevant institutions</p> |
| <p>Friday, 18 May 13:15–14:45 RAIL (MoT)</p> | <p>Coordinating Body of Indigenous Organizations of the Amazon Basin (COICA) Mr. Juan Carlos Jintiach juancarlos.jintiach@gmail.com +59 3 99548494</p> | <p>AMAZON : Alternative "Indigenous Redd+"/ Dialogue COICA, States and Environmentalists The Coordination of Indigenous Organizations of the Amazon Basin (COICA) will support the proposed "Indigenous Redd+" specific to the Amazon, seeking dialogue and consensus with presentatives of states and environmental organizations.</p> |
| <p>Friday, 18 May 18:15–19:45 SOLAR (MoE)</p> | <p>Global Witness Limited Ms. Chloe Fussell cfussell@globalwitness.org +44 7790 464596</p> | <p>How REDD+ can tackle drivers of deforestation and forest degradation To protect forests, REDD+ must tackle the economic, production, consumption and governance issues that drive deforestation and forest degradation. The Ecosystems Climate Alliance will discuss how REDD+ money can be used to address these drivers.</p> |
| <p>Friday, 18 May 18:15–19:45 METRO (MoT)</p> | <p>International Food Policy Research Institute (IFPRI) Ms. Susan Buzzelli Tonassi s.buzzelli@cgiar.org +1 626 4979681</p> | <p>Status of knowledge on how agriculture can contribute to adaptation and mitigation What we know already, and what rapid gains in knowledge are feasible, to advance synergies between adaptation and mitigation in the interlinked areas of adaptive agricultural practices, greenhouse gas accounting for farming systems and landscapes, safeguards for poor producers and consumers, and the wider context of food demand and food security.</p> <p>Speakers: Representatives of The World Bank and the Southern African Confederation of Agricultural Unions (SACAU)</p> |
| <p>Friday, 18 May 18:15–19:45 WIND (MoE)</p> | <p>Tebtebba Foundation Mr. Raymond de Chavez raymond@tebtebba.org +63 74 4447703</p> | <p>The Durban Platform - Challenges and Opportunities for Indigenous Peoples Indigenous peoples will share their assessment of the Durban Platform. Are there opportunities for further ensuring respect and recognition for their rights, for full and effective participation and recognition of their traditional knowledge? What challenges does the platform present?</p> <p>Speakers: Speakers: Ms. Victoria Tauli-Corpuz, Executive Director, Tebtebba; Mr. Joseph Ole Simel, Executive Director, MPIDO, Kenya; Ms. Tarcila Rivera Zea, Executive Director, Chirapaq, Peru; Ms. Joan Carling, Secretary General, AIPP</p> |

| Time/Room | Organizer | Title / Theme / speakers |
|---|--|---|
| <p>Friday, 18 May 18:15–19:45 RAIL (MoT)</p> | <p>Wuppertal Institute for Climate, Environment and Energy Mr. Wolfgang Sterk wolfgang.sterk@wupperinst.org +49 202 2492149</p> | <p>Designing New Market Mechanisms The Durban conference defined a new market mechanism, with the modalities and procedures to be adopted this year. This side event will convene an expert discussion on how the new mechanism should be designed to scale up mitigation actions while safeguarding environmental integrity.</p> <p>Speakers: Wuppertal Institute and other research organisations</p> |
| <p>Friday, 18 May 20:00–21:30 WIND (MoE)</p> | <p>CANCELLED by Organizer</p> <p>Overseas Development Institute (ODI) Mr. William McFarland w.mcfarland@odi.org.uk +44 207 9228202</p> | <p>CANCELLED by Organizer</p> <p>The Effectiveness of Climate Finance Two years into the commitments made to scale up fast start climate finance, it is essential to understand how well these funds have been spent. This session will consider the challenges of ensuring the effective use of climate finance, including transparency and accountability on contributions.</p> <p>Speakers: Speakers will include senior researchers from ODI, WRI, and Brookings; representatives of multilateral financial institutions and implementing agencies; and representatives developing country governments</p> |
| <p>Friday, 18 May 20:00–21:30 METRO (MoT)</p> | <p>Institut du développement durable et des relations internationales (IDDRI) Mr. Thomas Spencer thomas.spencer@iddri.org +33 6 88699988</p> | <p>From climate policies to long-term strategies in China. What's the impact of the current XII Five Year Plan on China's emissions trajectory? What are the necessary macroeconomic transformations and milestones towards 2020, and after? What could be China's contribution in renewed international negotiations?</p> <p>Speakers: IDDRI with Chinese Academy of Society Sciences, Tsinghua University, Beijing University.</p> |
| <p>Friday, 18 May 20:00–21:30 RAIL (MoT)</p> | <p>World Health Organization (WHO) Ms. Marina Maiero maierom@who.int +41 79 2134304</p> | <p>GEF/UNDP/WHO Global Project on Piloting climate change adaptation to protect human health spaces The project aims to: enhance early warning; build capacity; pilot specific intervention measures; and share lessons learned on protecting health from a range of hazards associated with CC. It involves MOH and relevant national partners in Barbados, Bhutan, China, Fiji, Jordan, Kenya and Uzbekistan.</p> |
| <p>Friday, 18 May 20:00–21:30 SOLAR (MoE)</p> | <p>Third World Network (TWN) Ms. Yvonne Miller ymiller@twngeneva.ch +41 22 9083550</p> | <p>Ensuring ambition and equity: Key issues and Challenges The "Durban package" comprises significant decisions and very important unresolved issues remain on the table for an ambitious and equitable climate architecture. The panel of speakers mainly from developing countries experts will address key issues and challenges in the negotiations.</p> |

| Time/Room | Organizer | Title / Theme / speakers |
|---|--|--|
| <p>Saturday, 19 May 13:15–14:45 METRO (MoT)</p> | <p>ClimateNet Mr. Axel Michaelowa dransfeld@perspectives.cc +49 40 39990691</p> | <p>NAMA developments in the MENA Region International experts and practitioners from the ground discuss the state of NAMA development in the MENA region. Case studies illustrate opportunities and challenges of NAMAs.</p> <p>Speakers: Axel Michaelowa and experts from host countries</p> |
| <p>Saturday, 19 May 13:15–14:45 RAIL (MoT)</p> | <p>ActionAid International Mr. Harjeet Singh harjeet.singh@actionaid.org +91 9810 36864</p> | <p>Beyond adaptation: Discussing reality of Loss & Damage from climate impacts in developing countries. Loss & Damage to the adverse impacts of climate change will be discussed in the context of mitigation & adaptation deficits. The concepts of risk, uncertainty, disruptive change & adaptation thresholds will be deliberated from the perspective of poor & vulnerable communities, ecosystem & countries</p> <p>Speakers: Sven Harmeling, Sönke Kreft, Sandeep Chamling Rai, Kit Vaughan and Harjeet Singh.</p> |
| <p>Saturday, 19 May 13:15–14:45 WIND (MoE)</p> | <p>International Federation of Organic Agriculture Movements (IFOAM) Mr. Robert Jordan r.jordan@ifoam.org +49 228 9265010</p> | <p>SBSTA & Rio+20: Agriculture & Food Security for Sustainable Development & Poverty Eradication IFOAM, WFP & UNCCD will highlight how the SBSTA and the Rio+20 process can empower vulnerable smallholders with robust, affordable & accessible climate-smart practices that improve nutrition & food security, build resilient livelihoods, and promote sequestration towards Zero Net Land Degradation</p> <p>Speakers: Andre Leu - IFOAM Catherine Zanev - World Food Program Bertrand Vincent - Convention on Combating Desertification</p> |
| <p>Saturday, 19 May 18:15–19:45 METRO (MoT)</p> | <p>climatepolicy.net e.V. Mr. Niklas Hoehne n.hoehne@ecofys.com +49 221 27070101</p> | <p>Status of the development, reporting and monitoring of internationally supported NAMAs Various research institutions will provide an overview of the latest developments on internationally supported NAMAs: new NAMA developments collected in the www.nama-database.org, an overview of trends, options for measurement, reporting and verification of NAMAs and needs for the future</p> <p>Speakers: Dr. Niklas Höhne</p> |
| <p>Saturday, 19 May 18:15–19:45 WIND (MoE)</p> | <p>Swiss Federal Institute of Technology (ETH Zurich) Ms. Paula Castro castro@pw.uzh.ch +41 76 7202166</p> | <p>Negotiating climate change – interests, strategies, bargaining success We present final research results on determinants of country positions, bargaining strategies and success in the climate negotiations. What drives countries' success in realizing their negotiation goals? Is power the key, or do bargaining strategies help? Country case studies illustrate the results.</p> |

| Time/Room | Organizer | Title / Theme / speakers |
|---|---|--|
| Saturday, 19 May 18:15–19:45 SOLAR (MoE) | German Committee for Disaster Reduction (DKKV) Mr. Karl-Otto Zentel Zentel@dkkv.org +49 228 6191290 | Risk resilient adaptation – the private sector Experts will present and discuss with the audience present findings of studies on the potential role, barriers to overcome and voluntary initiatives already undertaken by private sector for disaster risk reduction oriented adaption to climate change. |
| Saturday, 19 May 20:00–21:30 RAIL (MoT) | CANCELLED by Organizer ECONEXUS Ms. Helena Paul h.paul@econexus.info +44 207 4314357 | CANCELLED by Organizer The new bioeconomy: destroying ecosystem and climate resilience The proposed transition from fossil to biomass-based energy and materials could be even more destructive than the fossil oil era, yet many governments promote it. Presentations illustrate the likely impacts on climate, biodiversity, ecosystems and peoples. Speakers: EcoNexus - Helena Paul or Susanne Gura Global Justice Ecology Project - Anne Peterman Biofuelwatch - speaker to be confirmed Indigenous speaker (to be confirmed) |
| Saturday, 19 May 20:00–21:30 SOLAR (MoE) | CANCELLED by Organizer Forest Stewardship Council (FSC) Mr. Stefan Salvador s.salvador@fsc.org +4 228 3676624 | CANCELLED by Organizer ForCES – Forest Certification for Ecosystem Services With the GEF co-funded ForCES pilot project, FSC and partner organizations will research, analyze, and field test innovative ways how to evaluate and reward the provision of critical ecosystem services. Project work plans, field sites and first results will be presented. Speakers: Stefan Salvador |
| Monday, 21 May 13:15–14:45 METRO (MoT) | KfW Mr. Jochen Harnisch Jochen.Harnisch@kfw.de +49 69 74319695 | Progress in Adaptation to Climate Change – Approaches and Examples of Innovative Adaptation Finance The event provides a platform for innovative approaches to adaptation finance delivery and climate information tools to improve the resilience of development projects to climate change and extreme weather events. Examples for specific adaptation projects are presented. |
| Monday, 21 May 13:15–14:45 RAIL (MoT) | Humane Society International (HSI) Mr. Geoffrey Evans gevens@hsi.org +1 503 6888657 | Agriculture: Opportunities to Support Adaptation, Mitigation, and Social Goals Adaptation and mitigation efforts in the agricultural sector should support broader goals for humane, sustainable, and equitable food systems worldwide. Experts from leading NGOs will discuss efforts in the field, policy issues, and how the UNFCCC can support a holistic approach to agriculture. Speakers: Becky Chacko, Conservation International (TBC); Pipa Elias, Union of Concerned Scientists; Geoff Evans, Humane Society International; Others TBD. |

| Time/Room | Organizer | Title / Theme / speakers |
|--|---|--|
| Monday, 21 May 13:15–14:45 WIND (MoE) | German NGO Forum on Environment and Development Ms. Eva Filzmoser nicola@cdm-watch.org +32 49 9212081 | CDM Policy Dialogue Panel meets Civil Society As the High-Level Panel on the CDM Policy Dialogue is assessing experiences with the CDM, civil society representatives from Asia, Africa and Latin Americas will present both, positive as well as negative lessons learnt from CDM projects. Speakers: (tbc) |
| Monday, 21 May 18:00–19:30 SAAL BEETHOVEN (Hotel Maritim) | Secretariat of the United Nations Framework Convention on Climate Change (UNFCCC) Mr. Alejandro Kilpatrick akilpatrick@unfccc.int +49 228 8151764 | Consultations by the co-chairs of the work programme on long-term finance This two-part event will offer the Co-Chairs the opportunity to receive valuable inputs related to the work programme on long-term finance. |
| Monday, 21 May 18:15–19:45 RAIL (MoT) | Forestry and Forest Products Research Institute (FFPRI) Ms. Naoko Tsukada Inamoto naokotkd@ffpri.affrc.go.jp +81 29 8298365 | Development of NFMS and MRV system for REDD+ -Learning from Demonstration Activities- Robust, transparent and operational MRV system and NFMS are essential for the effective implementation of REDD+. Based on national level experiences in Cambodia, Vietnam and Japan, possibilities and further challenges on development of forest carbon monitoring will be discussed. Speakers: Mitsuo Matsumoto Yasumasa Hirata Two other speakers |
| Monday, 21 May 18:15–19:45 SOLAR (MoE) | International Centre for Trade and Sustainable Development (ICTSD) Ms. Natalia Cubilla ncubilla@ictsd.ch +41 22 9178497 | Addressing carbon leakage and competitiveness concerns for enhanced mitigation action Concerns for carbon leakage and competitiveness distortions are well spread and might prevent effective mitigation action. Related is the use of unilateral measures, in turn a source of tension. This session will assess the risks and explore solutions so as to enhance ambition on mitigation |
| Monday, 21 May 18:15–19:45 METRO (MoT) | ACT Alliance - Action by Churches Together (ACT Alliance) Mr. Isaiah Kipyegon Toroitich Isaiah.Toroitich@actalliance.org +41 22 7916245 | Climate Finance International climate finance Speakers: Mattias Södeberg |
| Monday, 21 May 18:15–19:45 WIND (MoE) | Institute for Agriculture and Trade Policy (IATP) Ms. Eleonore Wesslerle ewesslerle@iatp.org +1 612 8703425 | Critical agriculture issues in the UNFCCC: mitigation, adaptation, loss and damage Experts from the Institute for Agriculture and Trade Policy, ActionAid International and the Ecumenical Advocacy Alliance will examine agriculture issues within the UNFCCC including: loss and damage, mitigation targets and ways to achieve them, and agroecological approaches for adaptation. |
| Tuesday, 22 May 13:15–14:45 METRO (MoT) | World Business Council for Sustainable Development (WBCSD) Ms. Estelle Geisinger geisinger@wbcSD.org +41 22 8393191 | Getting the energy mix right for 2050 A historical perspective on the current energy mix and the technology, market and policy considerations for a 2050 world of 9 billion – living well and within natural resource limits. A discussion on what we need to do now and into the future to achieve this vision. |

| Time/Room | Organizer | Title / Theme / speakers |
|--|---|---|
| Tuesday, 22 May 13:15–14:45 WIND (MoE) | CANCELLED by Organizer United Nations University (UNU) Ms. Koko Warner warner@ehs.unu.edu +49 228 8150226 | CANCELLED by Organizer Evidence on the spectrum of loss & damage from case studies worldwide UNU presents evidence of loss & damage related to climate change, food & livelihood security, from case studies in LAC, Africa, & Asia. Delegates & experts discuss policy implications & ways forward. |
| Tuesday, 22 May 18:15–19:45 SOLAR (MoE) | International Emissions Trading Association (IETA) Mr. Cedric Ammann ammann@ieta.org +41 22 7370500 | New Market Mechanisms New Market Mechanisms: involvement and ideas from the private sector |
| Tuesday, 22 May 18:15–19:45 WIND (MoE) | Climate Action Network International (CAN International) Ms. Montana Burgess mburgess@climatenetwork.org +977 1 6915649 | ADP, KP and LCA: Pathway to Qatar and 2015 How to build a workplan across KP, LCA and ADP to ensure that we build incrementally toward a successful 2015 protocol. |
| Wednesday, 23 May 13:15–14:45 METRO (MoT) | Energy Research Centre of the Netherlands (ECN) Ms. Heleen de Coninck deconinck@ecn.nl +31 224 564316 | Visions for the Technology Mechanism With the TEC up and running and the Climate Technology Centre emerging, the Technology Mechanism is almost operational to start enhancing climate technology development and transfer. ECN and WRI organise a discussion on how it can positively contribute to existing adaptation and mitigation efforts. Speakers: Anticipated speakers include experts from WRI and ECN, TEC members and bidders for the CTC. |
| Wednesday, 23 May 13:15–14:45 WIND (MoE) | World Bank Mr. Jarl Krausing jkrausing@worldbank.org +1 571 3440470 | How best to incentivize low emission development in developing countries? This side event will discuss World Bank initiatives and analytical work to support developing countries moving to low emission development. Based on real world project experiences the discussion will include experience with the CDM and new approaches under development including new market mechanism |
| Wednesday, 23 May 18:15–19:45 WIND (MoE) | European Business Council for Sustainable Energy (e5) Mr. Julio Lambing julio.lambing@e5.org +49 221 92230506 | Prosperity, Politics & People. Necessary framework (environment) for sustainable forest ppp project Business models for forest conservation help to develop economic structures which create and strengthen local markets and value chains. Additionally they have to provide the political participation of the local community to ensure their justice and dignity. How to design such business models? Speakers: Dirk Walterspacher (Forest Finance, Managing Director), Vicky Tauli-Corpuz (Tebtebba Foundation, Executive Director), Kate Dooley (FERN, Forests and climate campaigner), Samuel Nnah Dobé tbc. (Centre pour le Développement et l'Environnement) |

| Time/Room | Organizer | Title / Theme / speakers |
|--|---|--|
| <p>Wednesday, 23 May 18:15–19:45 METRO (MoT)</p> | <p>International Centre for Research in Agroforestry (ICRAF) Mr. Henry Neufeldt h.neufeldt@cgiar.org +254 20 7224238</p> | <p>Forest climate links based on influencing the water cycle: need for climate policy beyond carbon Tree cover influences rainfall, but little attention is paid to the direct and tangible influences that trees and forests have on the local and regional climate. Future research needs to include these effects. The ICRAF, CIFOR and ZEF side event will inform stakeholders of research and action needs.</p> |
| <p>Thursday, 24 May 13:15–14:45 METRO (MoT)</p> | <p>WWF (WWF) Ms. Barbara Lueg barbara.lueg@wwf.de +49 30 311777241</p> | <p>Achieving the objective of USD 100 billion by 2020 The event provides a platform to discuss approaches to estimate additional costs and investments, as well as investments risks for low carbon development pathways by 2020. Existing and new potential sources of funding and risk coverage will be explored and assessed in respect to their viability.</p> <p>Speakers: Athena Ronquillo-Ballesteros Richard Sherman Norbert Gorißen Dr. Jochen Harnisch Mark Lutes</p> |
| <p>Thursday, 24 May 13:15–14:45 TBC</p> | <p>Secretariat of the United Nations Framework Convention on Climate Change (UNFCCC) Ms. Kay Merce kmerce@unfccc.int +49 228 8151507</p> | <p>Joint Implementation Supervisory Committee: question and answer session The Joint Implementation Supervisory Committee will explain its work programme and the progress made so far, and answer questions from the audience</p> |
| <p>Thursday, 24 May 18:15–19:45 SOLAR (MoE)</p> | <p>Climate Policy Initiative, Inc (CPI) Ms. Anne Montgomery admin@cpisf.org +1 415 2025846</p> | <p>Tracking Emissions and Mitigation Actions: Learning from Practices in China, Germany, Italy, the US Climate Policy Initiative hosts a discussion on national MRV systems for emissions and mitigation actions, presenting its review of systems in four nations. Experts will reflect on existing practice, needs, and opportunities to improve systems.</p> <p>Speakers: Kath Rowley and Julia Zuckerman, CPI; Brian Mantlana, Environmental Affairs Dept, South Africa; Bill Irving, US EPA; Teng Fei, Tsinghua University, China</p> |
| <p>Thursday, 24 May 18:15–19:45 METRO (MoT)</p> | <p>CANCELLED by Organizer</p> <p>The Gaia Foundation Ms. Teresa Anderson teresa@gaianet.org +44 7984 932655</p> | <p>CANCELLED by Organizer</p> <p>What is Climate Smart Agriculture: a promise or threat for small farmers and climate justice? "Climate Smart Agriculture" has been called a "triple win" for adaptation, mitigation & food security. Reliance on carbon markets and top-down decision making could however lead to more land grabs & destructive practices rather than supporting agroecology and peasant agriculture.</p> |

| Time/Room | Organizer | Title / Theme / speakers |
|--|--|---|
| Thursday, 24 May 18:15–19:45 WIND (MoE) | International Institute for Sustainable Development (IISD) Ms. Jessica Boyle jboyle@iisd.ca +1 613 2389886 | Developing Low-Carbon Development Pathways: The Kenyan Experience The side event will examine a sectoral scenarios approach to identifying low-carbon pathways, drawing on the experience of Kenya. Speakers: Government of Kenya, IISD, ECN and other invited guests |

III. Exhibits²

The exhibition area in the Hotel Maritim includes 22 Exhibit booths on a range of subjects relating to the Convention. Owing to the high number of applications, there will be different Exhibits during the first week and the second week, with a total number of 38 Exhibits over the fortnight of the conference.

Exhibits will take place throughout the conference. The stand numbers in this table correspond to those on the floor plan on [page 29](#).

A. List of Exhibits

Legend:

| |
|-------------------------------|
| Adaptation and related issues |
| Mitigation and related issues |
| Cross-cutting issues |
| Others |

| Organizer | Theme | Scheduled |
|--|--|-----------------------------|
| Brahma Kumaris World Spiritual University (BKWSU) Ms. Marion Mews cologne@de.bkwsu.org +49 221 3401860 | Sustainable capacity building: Empowering individuals and communities to act. The Brahma Kumaris World Spiritual University showcase their work on solar energy, demonstrating that growing a good green economy requires all of us. To sustain this economy requires building the capacity of each of us. | Stand 1 14 - 19 May 2012 |
| Center for International Forestry | CIFOR advances human wellbeing, | Stand 17 |

² Descriptions of Exhibits have been reproduced as received.

| Organizer | Theme | Scheduled |
|---|---|------------------------------|
| Research (CIFOR) Ms. Levania Santoso lsantoso@cgiar.org +62 251 8622622 | environmental conservation and equity by conducting research to inform policies and practices that affect forests in developing countries. CIFOR is one of 15 centres within the Consultative Group on International Agricultural Research (CGIAR). www.cifor.org | 14 - 19 May 2012 |
| Centre for Community Economics and Development Consultants Society (CECOEDECON) Mr. Sharad Joshi sharad_jp1@sancharnet.in +91 141 2771488 | The exhibit will focus on how agriculture is being negotiated in the negotiation text & the NAMAS, whether the proposed climate smart technologies are leading to increased soil carbon stocks and impacts of climate change on small farmers | Stand 2 14 - 19 May 2012 |
| Climate Action Network International (CAN International) Ms. Montana Burgess mburgess@climatenetwork.org +977 1 6915649 | Climate Action Network-International presents the Fossil of the Day Awards at 18:00 daily! | Stand 22 14 - 25 May 2012 |
| ClimateNet Mr. Axel Michaelowa dransfeld@perspectives.cc +49 40 39990691 | NAMA development in the MENA region - our experts are available for discussing cutting edge developments of NAMAs. We will distribute the latest research. | Stand 9 14 - 19 May 2012 |
| Ecologic Institute Ms. Karin Beese karin.beese@ecologic.eu +49 30 86880151 | The current status of regional and transnational climate change adaptation in the Baltic Sea region will be presented by the projects RADOST "Regional Adaptation Strategies for the German Baltic Sea Coast" and BALTADAPT. Posters, reports, videos, and interactive climate atlases will be displayed. | Stand 5 14 - 19 May 2012 |
| Energy Research Centre of the Netherlands (ECN) Ms. Heleen de Coninck deconinck@ecn.nl +31 224 564316 | Recent publications by the Energy research Centre of the Netherlands (ECN). | Stand 12 19 - 25 May 2012 |
| European Business Council for Sustainable Energy (e5) Mr. Julio Lambing julio.lambing@e5.org +49 221 92230506 | Forest Conservation, Afforestation and Climate Justice: European Business can offer pragmatic business models that provide new income perspectives in the rural and urban surroundings of forests, thereby reducing the pressure for deforestation. | Stand 16 19 - 25 May 2012 |
| German Committee for Disaster Reduction (DKKV) Ms. Birgit zum Kley-Fiquet zum.kley@dkkv.org +49 228 6191297 | DKKV the German Platform for Disaster Reduction within ISDR and its members from private sector, humanitarian, development and science present and inform | Stand 18 14 - 19 May 2012 |

| Organizer | Theme | Scheduled |
|---|--|------------------------------|
| | about their concepts and recent progress made to integrate DRR and Adaptation to Climate Change by refining and improving DRR tools | |
| German Development Institute (DIE - Bonn) Ms. Britta Horstmann Britta.Horstmann@die-gdi.de +49 228 94927208 | Climate change related research results from the German Development Institute / Deutsches Institut für Entwicklungspolitik (DIE) | Stand 15 19 - 25 May 2012 |
| Germany Ms. Anja Schüler anja.schueler@bmu.bund.de +49 172 3649219 | Germany is pleased to present its climate policy to its guests. The transformation of the energy system means the move towards the age of renewables and energy efficiency. Concerning this matter, we would like to inform about our plans and solutions. | Stand 19 14 - 19 May 2012 |
| Global Forest Coalition (GFC) Ms. Simone Lovera simone.lovera@globalforestcoalition.org +595 21 663654 | Forests and Climate Change: Addressing the Drivers and Supporting Indigenous territories and Community Conserved Areas | Stand 16 14 - 19 May 2012 |
| ICLEI-Local Governments for Sustainability (ICLEI) Mr. Yunus Arikan yunus.arikan@iclei.org +49 228 97629920 | ICLEI - Local Governments for Sustainability will present the latest outcomes of worldwide spread local climate action, including Resilient Cities Congress, carbonn Cities Climate Registry, MXC Pact, Durban Adaptation Charter. | Stand 11 14 - 25 May 2012 |
| International Centre for Research in Agroforestry (ICRAF) Mr. Henry Neufeldt h.neufeldt@cgiar.org +254 20 7224238 | The World Agroforestry Centre will present work on mitigation, adaptation and food security | Stand 14 19 - 25 May 2012 |
| International Centre for Trade and Sustainable Development (ICTSD) Ms. Natalia Cubilla ncubilla@ictsd.ch +41 22 9178497 | The Global Platform on Climate Change, Trade and Sustainable Energy of the International Centre for Trade and Sustainable Development (ICTSD) mobilizes technical and political expertise to address the nexus between trade, climate change and energy. | Stand 8 14 - 19 May 2012 |
| International Emissions Trading Association (IETA) Mr. Cedric Ammann ammann@ieta.org +41 22 7370500 | IETA - International Emissions Trading Association | Stand 10 19 - 25 May 2012 |
| International Food Policy Research Institute (IFPRI) Ms. Susan Buzzelli Tonassi s.buzzelli@cgiar.org +1 626 4979681 | Co-organized by the Consultative Group on International Agricultural Research (CGIAR), the CGIAR Research Program on Climate Change, Agriculture and Food Security (CCAFS) & the | Stand 3 14 - 19 May 2012 |

| Organizer | Theme | Scheduled |
|--|---|------------------------------|
| | International Food Policy Research Institute (IFPRI), the booth features outputs from the CGIAR system. | |
| Japan Mr. Hiroshi Seike hiroshi.seike@mofa.go.jp +81 3 55018493 | This exhibition focuses on various kinds of cooperation on climate change especially bilateral and regional activities and initiatives. | Stand 6 14 - 25 May 2012 |
| Mediators Beyond Borders (MBB) Mr. Thomas Fiutak fiuta001@umn.edu +1 651 7241822 | Mediators Beyond Borders International advocates for the use of mediation and other cooperative and transparent decision making processes as specifically applied to climate change matters. | Stand 1 19 - 25 May 2012 |
| Munich Climate Insurance Initiative (MCII) Ms. Koko Warner warner@ehs.unu.edu +49 228 8150226 | MCII presents publications related to loss and damage, disaster risk management, and insurance solutions. | Stand 12 14 - 19 May 2012 |
| PAIRVI Associates (PAIRVI) Mr. Ajay Kumar Jha pairvidelhi@rediffmail.com +91 141 2771488 | Need for robust municipal and international regime in view of the constraints to address the issues of liability and redress | Stand 2 19 - 25 May 2012 |
| South Centre Ms. Mariama Williams Williams@southcentre.org +41 22 798431759 | Equity Sustainable Development and Climate Change. | Stand 5 19 - 25 May 2012 |
| Sustainable Population Australia Inc. (SPA) Ms. Jane O'Sullivan j.osullivan@uq.edu.au +61 7 33798090 | Reproductive rights are key to a safe and stable future. Food insecurity due to overpopulation is creating humanitarian crises, exacerbated by climate change. Lack of access to family planning prevents women protecting their health and their family's wellbeing from unwanted pregnancies. | Stand 3 19 - 25 May 2012 |
| Swiss Federal Institute of Technology (ETH Zurich) Ms. Paula Castro castro@pw.uzh.ch +41 76 7202166 | The exhibit will display the research being done at the ETH Zurich and the University of Zurich on the climate change negotiations, climate and conflict, climate finance, diffusion of renewable energy policies, and the performance of market mechanisms. | Stand 15 14 - 19 May 2012 |
| Third World Network (TWN) Ms. Yvonne Miller ymiller@twngeneva.ch +41 22 9083550 | Display updates and documents relative to the ongoing negotiations. In the past we were given an exhibit next to the plenaries, since negotiators like to pick up our updates in the morning. | Stand 4 19 - 25 May 2012 |
| Transport Research Foundation (TRF) Ms. Anne Binsted | Bridging the Gap between transport and climate change. Visit | Stand 4 14 - 19 May 2012 |

| Organizer | Theme | Scheduled |
|---|--|------------------------------|
| abinsted@trl.co.uk +44 1344 770568 | this stand for information on transport and climate change from TRF, GIZ, UITP, Veolia Transdev and ITDP, which highlights opportunities and options for action to ensure adequate support for sustainable low carbon transport post 2012. | |
| United Nations Development Programme (UNDP) Ms. Jennifer Baumwoll jennifer.baumwoll@undp.org +1 212 9065012 | Sharing information and lessons learned emerging from the work UNDP is doing to support developing countries to address climate change. | Stand 21 14 - 25 May 2012 |
| United Nations University (UNU) Ms. Koko Warner warner@ehs.unu.edu +49 228 8150226 | UNU presents publications related to case studies, evidence of sustainable development, climate, and human security, indigenous people, adaptation, and resilience. | Stand 13 14 - 25 May 2012 |
| Wetlands International Ms. Susanna Tol susanna.tol@wetlands.org +0 6717 3162262470 | Peatlands are hotspots for emissions reductions worldwide. Wetlands International promotes emissions reductions under REDD+, NAMA's and LULUCF. | Stand 14 14 - 19 May 2012 |
| WMO/UNEP Intergovernmental Panel on Climate Change (IPCC) Mr. Gaetano Leone gleone@wmo.int +41 22 7308247 | IPCC Reports and documentation | Stand 20 14 - 25 May 2012 |
| World Business Council for Sustainable Development (WBCSD) Ms. Estelle Geisinger geisinger@wbcSD.org +41 22 8393191 | "Launch of new work on energy and climate theme. Including a new publication on The Energy Mix in keeping with a Vision 2050 strategy" | Stand 17 19 - 25 May 2012 |
| World Resources Institute (WRI) Ms. Raquel Gonzalez raquelgonzalez@gmail.com +1 202 7297847 | The World Resources Institute is a global environmental think tank that goes beyond research to put ideas into action. We work with governments, companies, and civil society to build solutions to urgent environmental challenges. | Stand 7 14 - 19 May 2012 |

B. Climate Change Kiosk

Where do I find information on the process and the secretariat?

The central point for information on climate change and the secretariat and its work is the **Climate Change Kiosk**, located in the foyer of the Hotel Maritim, where a range of documents are available in hard copy and electronic form. This includes selected hard copies of UNFCCC publications.

Contact information:

Mr. Alexander Saier

asaier@unfccc.int

C. Climate Change Publications Counter

Publications that are clearly attributed to a Party or an admitted observer organization that is not exhibiting may be distributed and displayed at the Climate Change Publications Counter, after approval. The counter is located on the ground floor in the central foyer of the Hotel Maritim. For approval, please provide a sample to the Observer Organizations Liaison Team at the Side Events and Exhibits Coordination Office (see [page 6](#)). The counter cannot manage large volumes, but will assist in changing the range of documents on display.

Organizers of Exhibits are requested to display and distribute documents at their own booths. Side Event advertisements and invitations can be posted on the noticeboards located opposite the Information Counter.

Documents that are deposited elsewhere or not attributed will be removed.

Contact information:

Ms. Edith Kimotho

ekimotho@unfccc.int

IV. Floor plans

A. Hotel Maritim Exhibit area

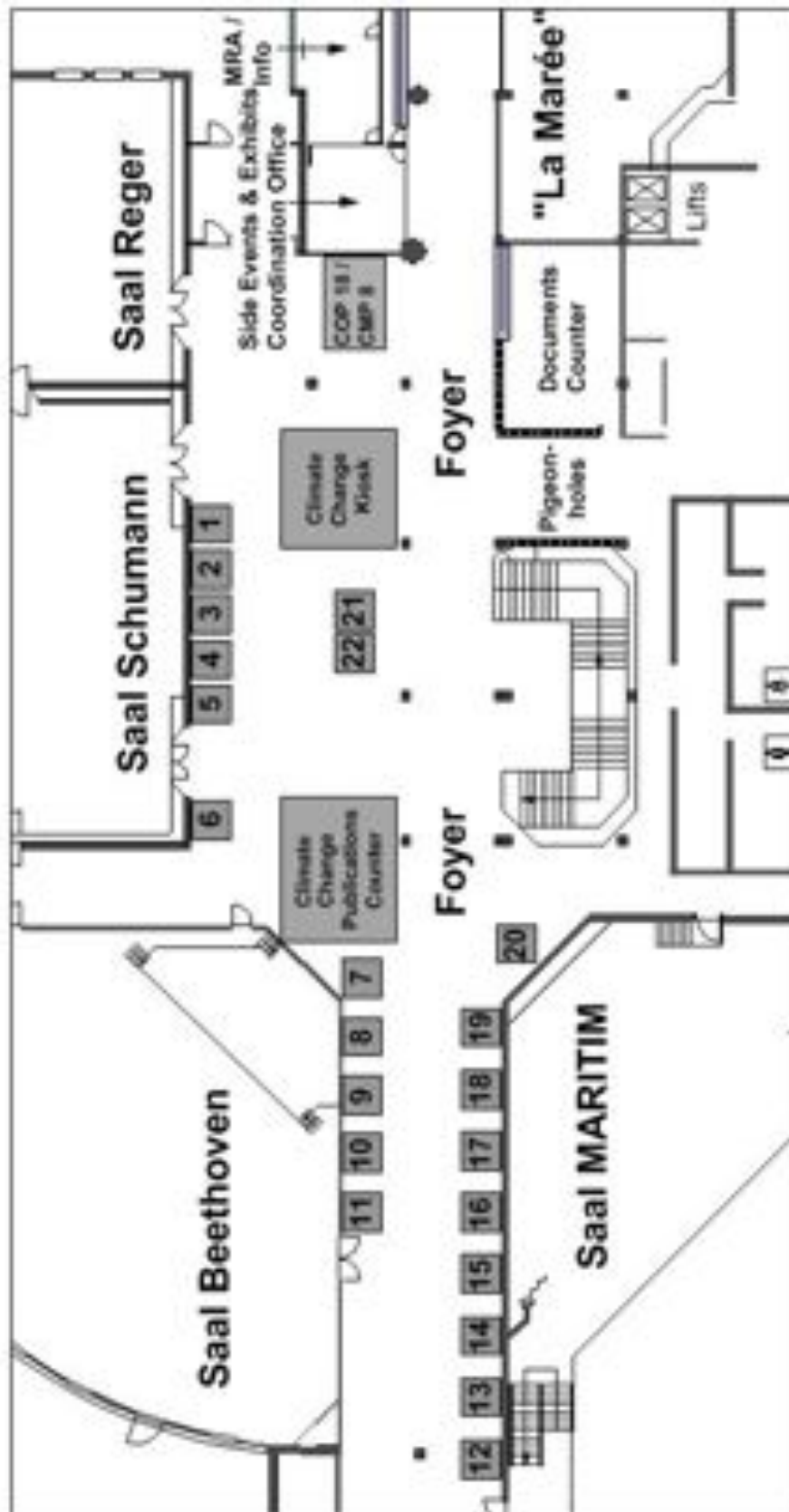

B. Hotel Maritim and surroundings

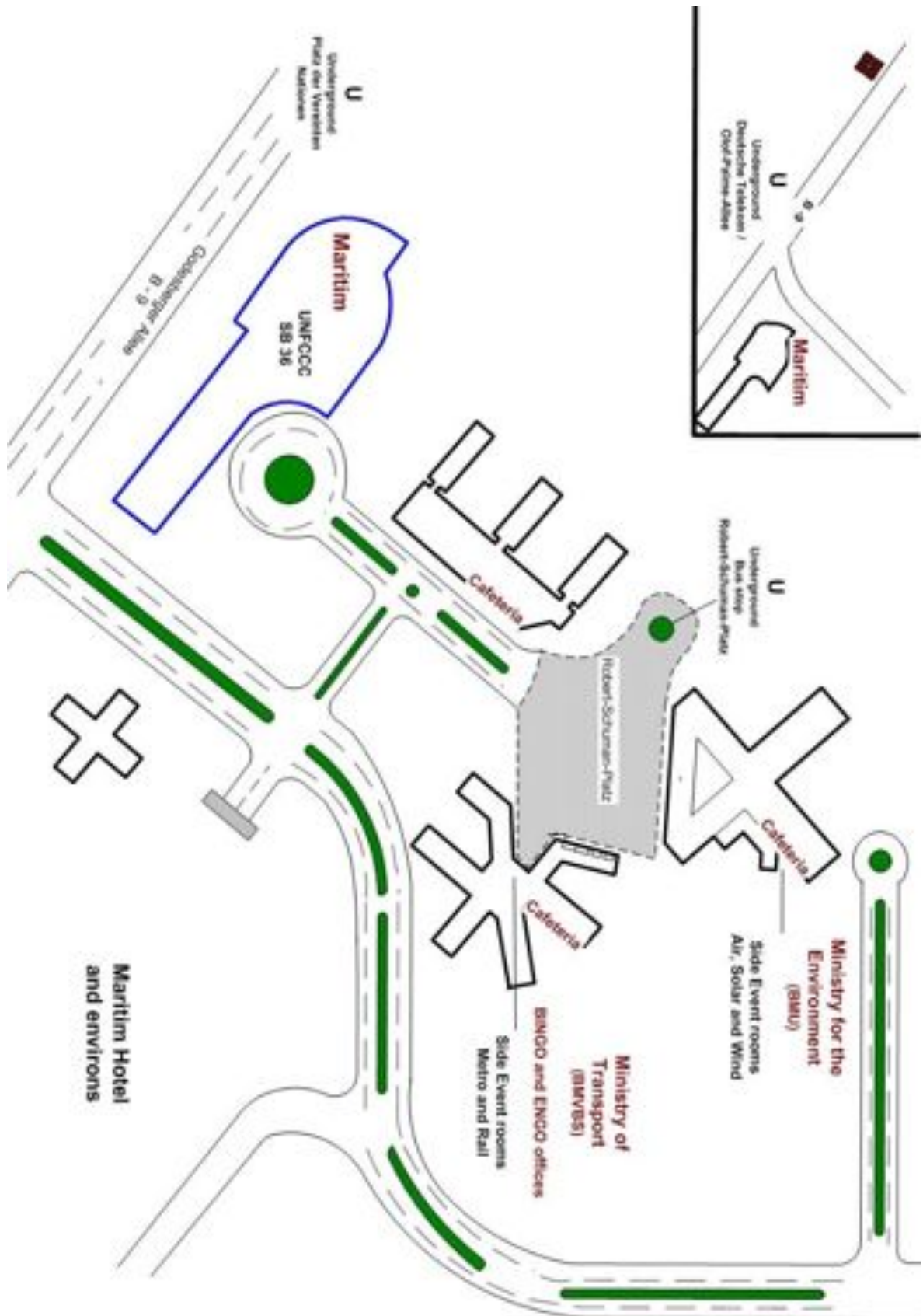

C. Ministry for the Environment (ground floor)

MINISTRY FOR THE ENVIRONMENT - GROUND FLOOR

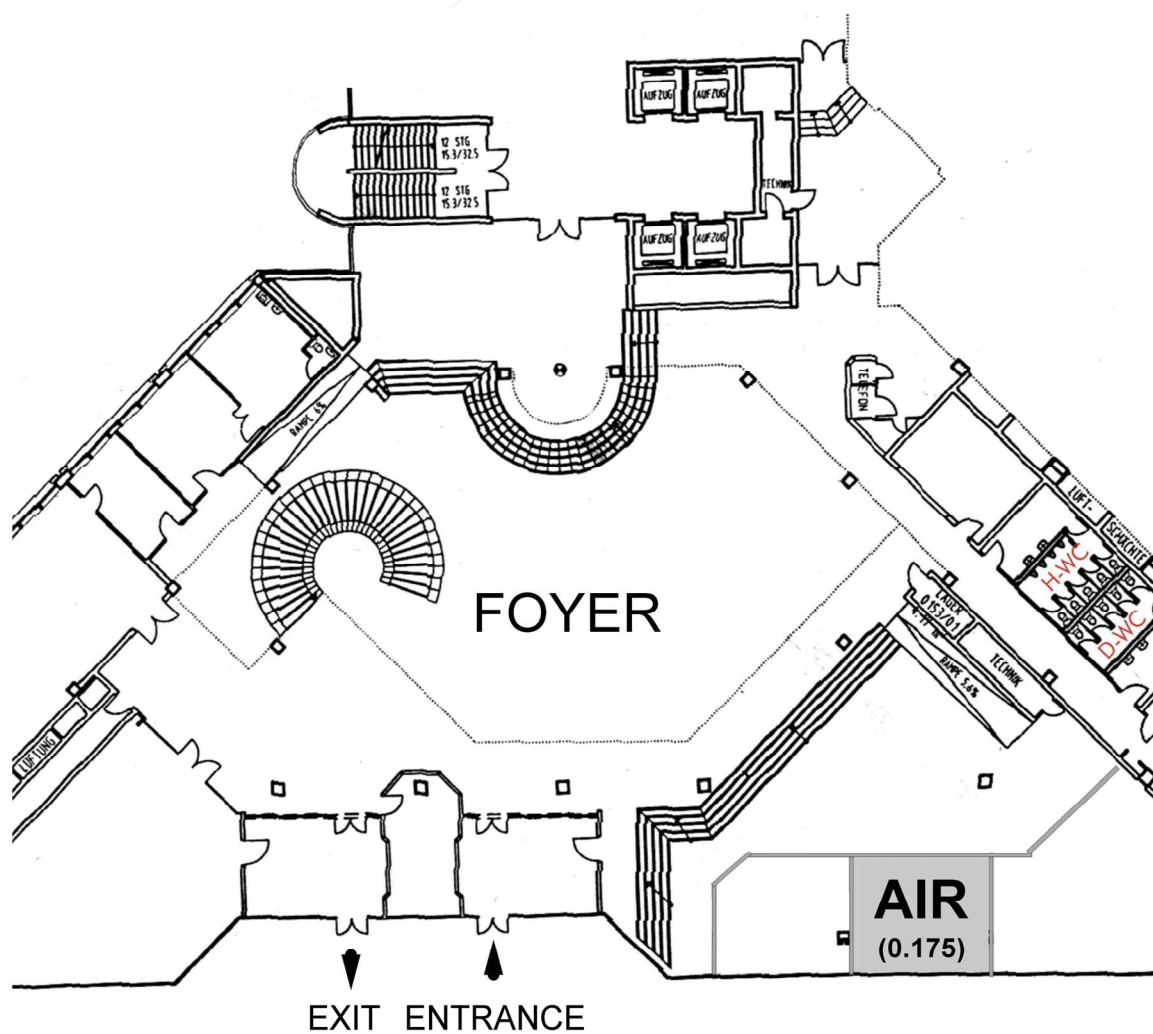

D. Ministry for the Environment (first floor)

MINISTRY FOR THE ENVIRONMENT - FIRST FLOOR

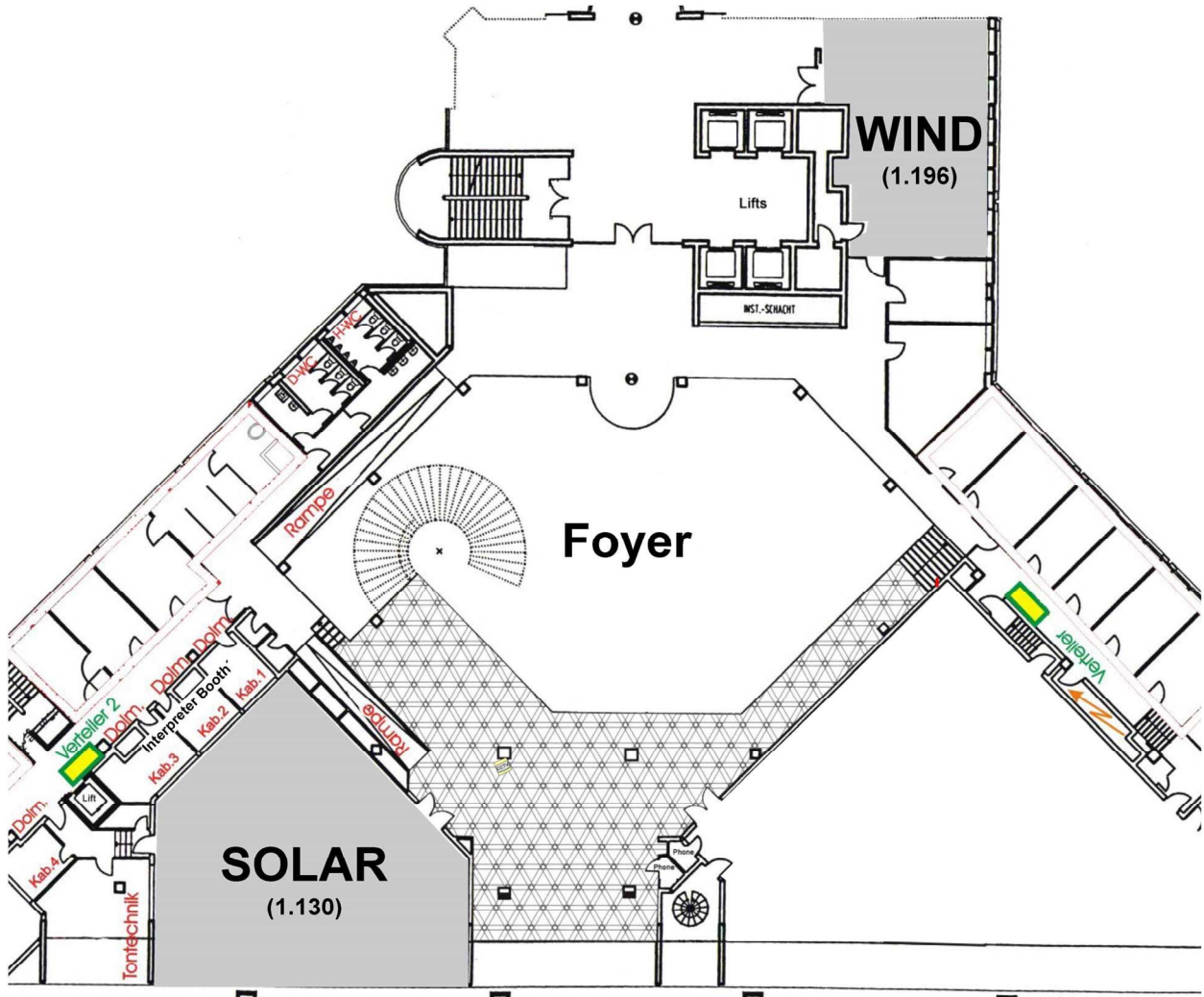

E. Ministry of Transport (ground floor)

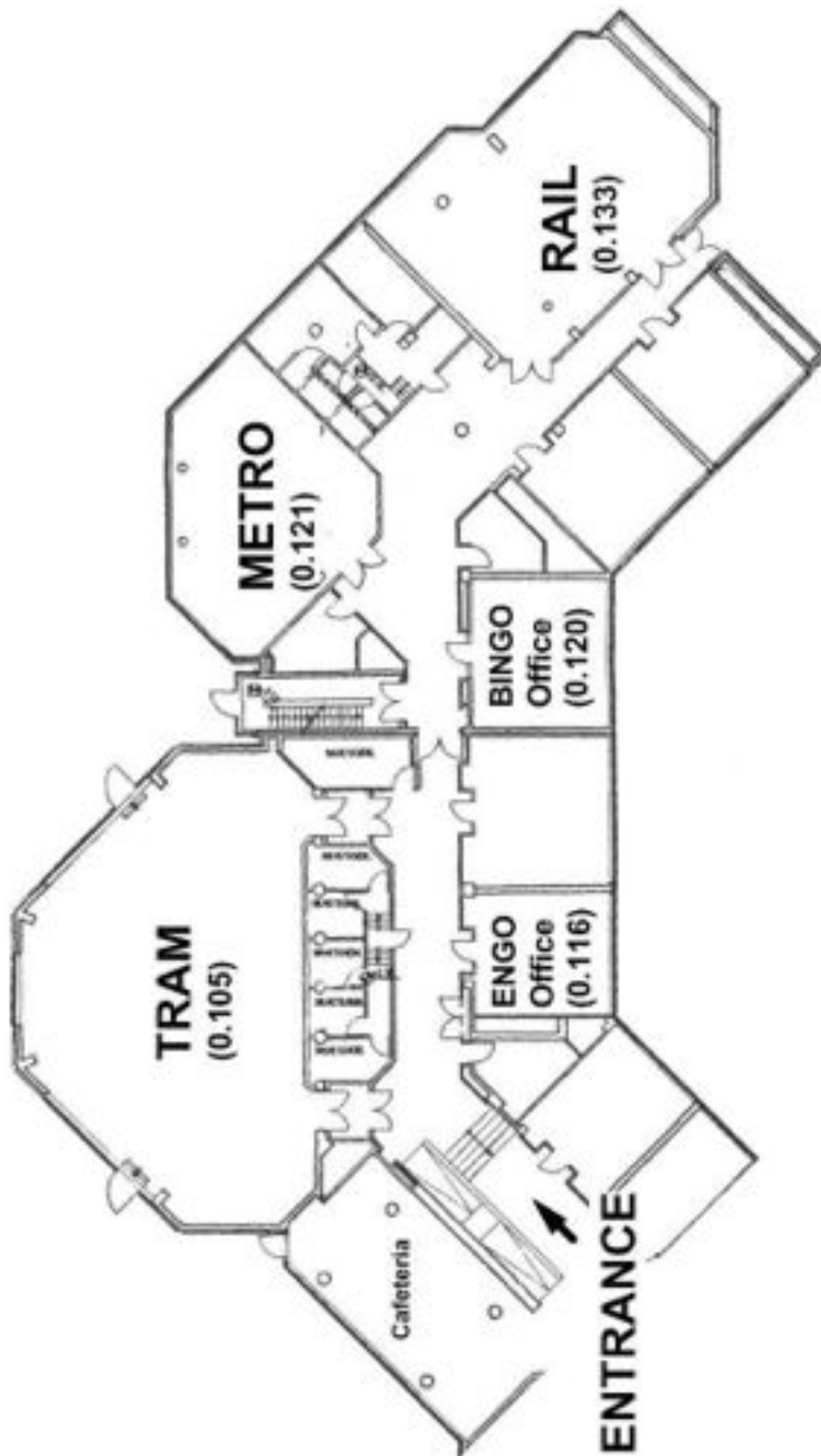

V. Observer organizations

A. NGO constituencies

The nine major groups identified as stakeholders in Agenda 21, the comprehensive plan of action for the Rio Declaration, are recognized as constituencies in the UNFCCC negotiation process. Plenary interventions, time permitting, are made per constituency, and their focal points interact with the secretariat as channels of communication with large groups of constituents.

The groups are:

- Business and industry non-governmental organizations (BINGO);
- Environmental non-governmental organizations (ENGO);
- Farmers non-governmental organizations (Farmers);*
- Indigenous peoples organizations (IPO);
- Local government and municipal authorities (LGMA);
- Research and independent non-governmental organizations (RINGO);
- Trade unions non-governmental organizations (TUNGO);
- Women and gender non-governmental organizations (Women and Gender);
- Youth non-governmental organizations (YOUNGO).

* Recognized as a constituency on a provisional basis pending a final decision on its status before COP 19.

B. Offices and contact information

The business and industry non-governmental organizations (BINGO) and the environmental non-governmental organizations (ENGO) constituencies have offices located on the [ground floor of the Ministry of Transport](#). For further information on the work of the constituencies, please contact:

BINGO

Ms. Andrea Bacher
International Chamber of Commerce
Tel: +33 1 49 53 28 48
andrea.bacher@iccwbo.org

IPO

Mr. Juan Carlos Jintiach
Coordinating Body of Indigenous Organizations
of the Amazon Basin
Tel: +593 2 3323 744
Juancarlos.jintiach@gmail.com

ENGO

Mr. Wael Hmaidan
Climate Action Network International
Tel: +961 3 506313
whmaidan@climatenetwork.org

LGMA

Mr. Yunus Arikan
ICLEI - Local Governments for Sustainability
Tel: +49 228 97 629 920
climate.center@iclei.org

Farmers*

Ms. Anette Engelund Friis
Danish Agriculture and Food Council
Tel: +45 30 83 10 51
aef@lf.dk

RINGO

Ms. Monica Alessi
Centre for European Policy Studies
Tel: +32 472 72 18 68
ringos@ceps.eu; monica.alessi@ext.ceps.eu

TUNGO

Ms. Anabella Rosemberg
International Trade Union Confederation

YOUNGO

Ming-Jay Shiao
SustainUS

Tel: +33 6 77 69 94 29
roseberg@tuac.org

Women and Gender
Ms. Gotelind Alber
genderCC - Women for Climate Justice
Tel: +49 151 15 240 802
g.alber@gendercc.net

Tel: +1 330 573 4670
mj@youthclimate.org

Mr. Abhishek Shrestha
Clean Energy Nepal
aviish27@gmail.com

C. Constituency meetings

| | | |
|------------------|------------|---|
| BINGO | 9–10 a.m. | Room WIND, Ministry for the Environment (daily) |
| Farmers* | 8–9 a.m. | Room METRO, Ministry of Transport (daily) |
| IPO | 9–10 a.m. | Room METRO, Ministry of Transport (daily) |
| LGMA | 9–10 a.m. | Terrace “Brunnenterrasse” at the Hotel Maritim (daily) |
| RINGO | 10–11 a.m. | Room WIND, Ministry for the Environment (only on 15, 17, 19, 22 and 24 May) |
| TUNGO | 9–10 a.m. | Room SOLAR, Ministry for the Environment (daily) |
| Women and Gender | 9–10 a.m. | Room AIR, Ministry for the Environment (daily) |
| YOUNGO | 8–9 a.m. | Room SOLAR, Ministry for the Environment (daily) |

Daily constituency meetings are also announced on the CCTV monitors and in the Daily Programme for the first day of the conference. To save paper consumption, the meetings will **not** be repeated in the Daily Programme from the second day onwards, except on those days when the default meeting room has to be changed

VI. Logistics

Please refer to the "[Information for Participants](#)" brochure for information on Meeting Room Assignment (MRA), press briefings and consignments.

A. Catering

If you wish to order catering for your Side Event, please directly liaise with the catering company servicing the venue of your event.

**Ministry of the Environment
Rooms SOLAR and WIND**
Mr. Alfons Esser
a.esser@DeutschePost.de

**Ministry of Transport
Rooms RAIL and METRO**
Ms. Monika Nipps
Tel: +49 228 30 08 691
bmvbs@l-und-d.de

The organizer must coordinate with the caterer to ensure that all food and drink is served after Side Events and is set up outside the rooms. It is the responsibility of the organizer to ensure that Side Event rooms and their surrounding areas are left in an appropriate state for the next meeting.

Food and drink is not permitted in the Side Event rooms!

Thank you for your cooperation.

B. Wi-Fi access

Wireless Wi-Fi Internet access is available for all participants at the Hotel Maritim, the Ministry for the Environment and the Ministry of Transport. Please find the log-in details below:

Hotel Maritim
Network: plugNplay
Password: none

Ministry for the Environment
Side Event rooms SOLAR and WIND
Network: bmu_dsl
Password: Klima2012

Ministry of Transport
Side Event rooms RAIL and METRO
Network: UNFCCC
Password: Bonn2012

VII. Notices

The Hotel and Ministry buildings are a non-smoking environment. Smokers are encouraged to enjoy the fresh air outside the conference venue.

Food and drink is not permitted in any of the meeting rooms. Your support is appreciated to keep the meeting rooms in an uncluttered and clean state for subsequent meetings. Please do not change the layout of the meeting rooms.

Future sessions and deadlines

COP 18/CMP 8

Monday, 26 November to Friday, 7 December 2012
Doha, Qatar

Online application period for Side Events and Exhibits:

COP 18/CMP 8

Tuesday, 7 August 2012, 11 a.m. (Central European Time) to
Friday, 10 August 2012, 5 p.m. (Central European Time)

Application deadline for admission of new observer organizations in time for

COP 19/CMP 9:

1 March 2013

Please check the UNFCCC website <http://unfccc.int> regularly for the deadlines for applications for Side Events and Exhibits at other UNFCCC sessions.



For more information: unfccc.int